



## 1999-2004 Ford Mustang QuickLIFT Installation Guide

### Step 1 - Unpack QuickLIFT system and verify contents.

Remove all items from the packing tube. You should have the following before beginning:

- \* (2) Gas Springs (**RT-QL-200-5A**) - *Be sure to cycle them a few times before installing!*
- \* (4) 3/16" steel multi-grip rivets
- \* (2) 3/16" Aluminum rivets (longer) - for center hole of hood brackets.
- \* (4) 5/16" head self-tapping sheet metal screws - fender brackets
- \* (2) Fender steel brackets - 90 degree angle
- \* (2) Hood steel brackets - 3 hole (angled)
- \* Printed Instructions



### Step 2 - Gather the required tools.

Please gather the following tools before you begin the installation:

- \* Power Drill
- \* (3/16" or indexed #11) & 5/32" drill bits
- \* 5/16" socket and socket wrench or nut-driver bit preferred
- \* Fine permanent marker or felt tip pen
- \* Tape Measure
- \* Masking Tape
- \* Hammer & center punch
- \* Rivet gun, capable of 3/16" rivets (most brands can handle this size)



Recommended: Craftsman standard or Swivel Riveter (shown - 974749) - \$9.99 to \$17.99

### Step 3 - Mark hood bracket centerline.

A. Gather masking tape, tape measure, a permanent marker and also the two angled hood brackets (3-mounting holes).

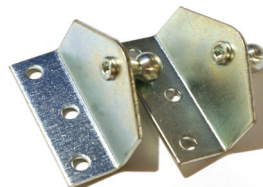

Hood Brackets

B. Place the bracket above the lip on the structural frame with the ball stud pointing outward or away from the vehicle. The base of the bracket should sit flat against the frame as shown. **Leave a small amount of room between the bottom of the bracket and the lip (1/16") to keep the bracket from riding up onto the lip.**



Mount above lip if stock hood

Copyright © 2003 Redline Tuning LLC. All Rights Reserved.

Use Measurement for  
Aftermarket hood

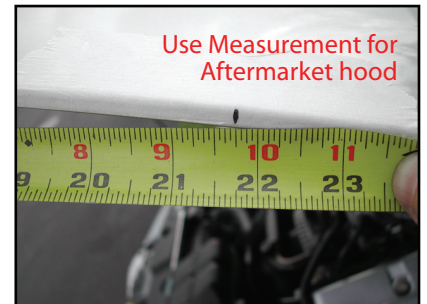

Use Measurement for  
Aftermarket hood



### Step 4 - Mark lower hole for drilling.

A. Holding angled bracket in place, mark the center of the lower hole using a permanent felt tip marker. Be sure the bracket is straight and sitting flat against the hood's frame as shown to the right.

B. Set bracket aside. Using a center punch and a hammer, tap the center of the mark you just made (this indentation will help guide the drill bit and keep it from wandering).

Place bracket back in place to be sure it is still centered where it should be.

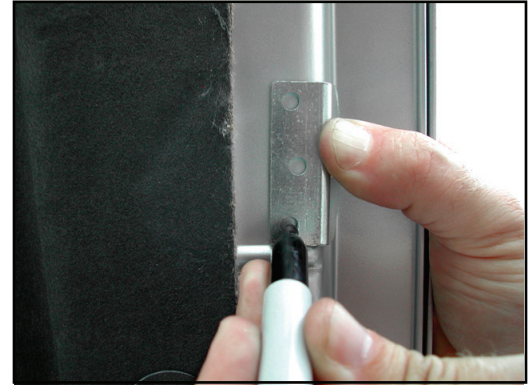

### Step 5 - Drill #11 indexed bit hole, or 3/16" hole.

A. Carefully drill the hole as shown to the right using a (#11 indexed bit) or (use 3/16" bit if #11 bit is not available).

If you do not have a #11 indexed bit, you can use the 3/16" bit, however you may have to test fit the rivet and slightly ream hole until rivet fits tightly through bracket and hole - 3/16" is slightly smaller than the #11 bit. Do not use any other drill bit sizes!

Wrap a piece of tape around the drill bit about 1/4" from the tip to prevent the bit from denting the hood skin. Use new and sharp bits! Photo in Step 7.



### Step 6 - Rivet lower end of bracket to hood.

A. Hold the bracket in position.

B. With the bracket lined up again, place the rivet through the bracket and hole with the long stem sticking outward - shown to the right. The rivet may require a few twists while pushing it in. Use one of 8 included rivets (two aluminum rivets used for center hole).

C. Check to be sure your rivet gun has the 3/16" rivet head installed, then slide rivet gun onto rivet. While applying downward force on rivet and bracket, firmly squeeze riveter handle multiple times until rivet gun pops and snaps off the rivet stem.

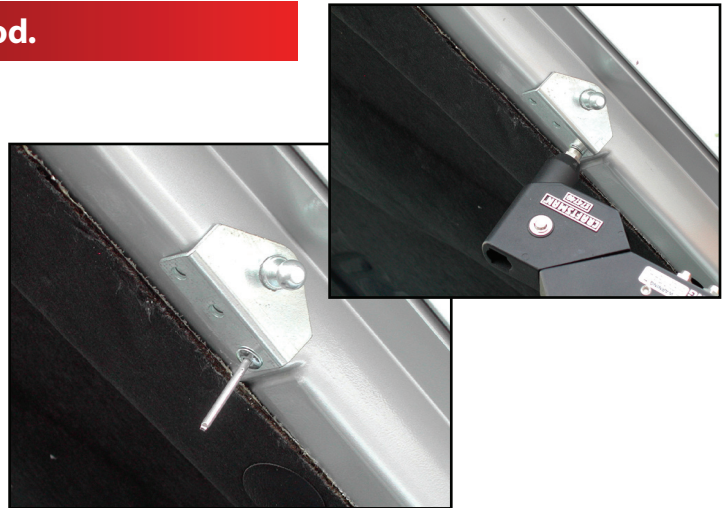

**Riveting Tips:**  
Visit <http://www.redlinetuning.com/QL-tips.html>

### Step 7 - Drill and rivet upper hole

A. Reposition or rotate bracket into the proper position against hood lip. Carefully drill the second hole through bracket hole and hood. Wrap end of drill bit 1/4" down from tip with tape to keep drill bit from pulling through and hitting hood skin.

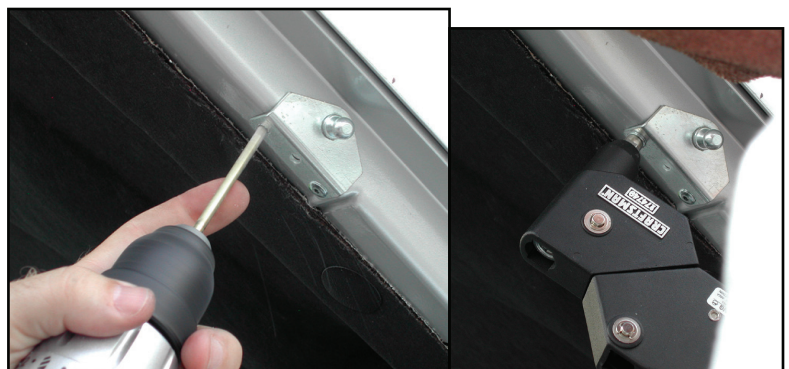
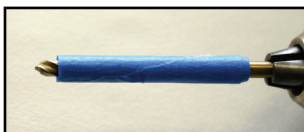

## Step 7 - Continued - Drill and install third rivet using 3/16" drill bit.

Carefully drill the third center hole (a 3/16" drill bit is required for the this hole) - follow same precautions. Then rivet using the Aluminum rivet (longer rivet, 2 included). This rivet helps stabilize the bracket and should be installed last.

## Step 8 - Repeat steps 3-7 and install the passenger side hood bracket.

A. Your hood has a symmetrical under structure (frame). Repeat Steps 3-7 to install the upper passenger hood bracket. Take your time.

## Step 9 - Position and mark first hole for driver's side fender bracket.

A. Hold the bracket in position as shown to the right. The bracket should sit **1"** from the fender with the ball stud pointing outward or away from the vehicle and approximately **3-3/4"** from center of upper fender bolt to the edge of the bracket.

The bracket will be touching the angled corner of the fender lip.

The bracket should span an area where two sections of steel are overlapping.

B. Mark right hole using a fine permanent marker.

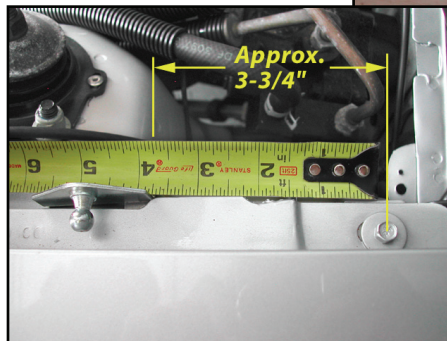

## Step 10 - Mark hole center before drilling right hole using 5/32" drill bit.

A. Using a center punch and a hammer, tap the center of the marked hole. This will help guide the drill bit and keep it from wandering during the following step.

B. Drill the right hole at the marked position using a sharp **5/32" drill bit**.

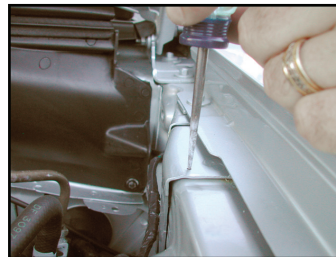

## Step 11 - Attach the upper or right end of the bracket to fender.

A. Using a color matching paint, touch up the area where you just drilled the hole.

B. Using a 5/16" socket and wrench, carefully screw the right or upper screw into the fender. Apply adequate pressure while screwing the sheet metal screw in - you will be creating threads through the layers of steel on the fender lip and it will require force.

## Step 12 - Mark center with marker and indent with center punch.

- Using a permanent marker, mark the second hole of the fender bracket.  
Be sure the bracket is parallel to the fender.
- Using a center punch and a hammer, tap the center of the marked hole. This will help guide the drill bit and keep it from wandering.

## Step 13 - Drill second hole and attach bracket.

- Drill the second hole at the marked position using a **5/32"** drill bit.
- Attach the bracket using the same 5/16" socket and wrench or a nut-driver attached to your drill.

Secure both screws and bracket at this time.



## Step 14 - Repeat steps 9-13 to attach the passenger fender bracket.

- Repeat Steps 9-13 to attach the passenger side fender bracket. The vehicle is symmetrical so the same locators can be used. Feel free to measure off of key areas to ensure a symmetrical installation.

## Step 15 - Cycle both gas springs 3 times

- CYCLE EACH GAS SPRING BEFORE INSTALLING** - firmly hold a gas spring with both hands by the thick cylindrical end - firmly press down on the floor or carpet and compress the spring. Do this to both gas springs a few times to lubricate the shaft and seals before installing them.



## Step 16 - Install the gas springs

- Install gas springs with large housing attached to the hood and the extending shaft connected to the fender ball-studs. Gas springs should snap onto the ball-stud securely at each end.